



## Uni-Dicht-P

Material: PA/\*POM  
 Farbe: grau (RAL 7032)  
 Zugentlastung: nach EN 50262, Ausf. A  
 Dichteinsatz: TPE  
 Einsatztemperatur: -20 °C bis 100 °C  
 Schutzart: IP 68

Material: PA (Nylon)/\*POM  
 Colour: grey (RAL 7032)  
 Strain relief: acc. to EN 50262, version A  
 Sealing insert: TPE  
 Temperature range: -20 °C to 100 °C  
 Protection type: IP 68

**181.00**



Gewinde Entry Thread AG	 mm	 mm	H mm	GL mm	HUGRO No.
M 12 x 1,5	4 - 6,5	15	21	8	181.1507
M 16 x 1,5	4 - 6,5	19	22	9	181.1707
M 16 x 1,5	5 - 8	19	22	9	181.1708
M 16 x 1,5	6,5 - 9,5	19	22	9	181.1710
M 20 x 1,5	4 - 6,5	22	23	9	181.2007
M 20 x 1,5	5 - 8	22	23	9	181.2008
M 20 x 1,5	6,5 - 9,5	22	23	9	181.2010
M 20 x 1,5	7 - 10,5	22	23	9	181.2011
M 20 x 1,5	4 - 6,5	24	23	9	181.2307
M 20 x 1,5	5 - 8	24	23	9	181.2308
M 20 x 1,5	6,5 - 9,5	24	23	9	181.2310
M 20 x 1,5	7 - 10,5	24	23	9	181.2311
M 20 x 1,5	9 - 13	24	23	9	181.2313
M 25 x 1,5	4 - 6,5	30/27	23	9	181.2507
M 25 x 1,5	5 - 8	30/27	23	9	181.2508
M 25 x 1,5	6,5 - 9,5	30/27	23	9	181.2510
M 25 x 1,5	7 - 10,5	30/27	23	9	181.2511
M 25 x 1,5	9 - 13	30/27	23	9	181.2513
M 25 x 1,5	11,5 - 15,5	30/27	23	9	181.2516
M 32 x 1,5	7 - 10,5	36/33	27	11	181.3211
M 32 x 1,5	9 - 13	36/33	27	11	181.3213
M 32 x 1,5	11,5 - 15,5	36/33	27	11	181.3216
M 32 x 1,5	14 - 18	36/33	27	11	181.3218
M 32 x 1,5	17 - 20,5	36/33	27	11	181.3221
M 40 x 1,5	11,5 - 15,5	46/43	34	11,5	181.4016
M 40 x 1,5	14 - 18	46/43	34	11,5	181.4018
M 40 x 1,5	17 - 20,5	46/43	34	11,5	181.4021
M 40 x 1,5	20 - 25	46/43	34	11,5	181.4025
M 40 x 1,5	24 - 28	46/43	34	11,5	181.4028
M 50 x 1,5	27 - 32	55/53	34	14	181.5032
M 50 x 1,5	29 - 34	55/53	34	14	181.5034
M 50 x 1,5	32 - 36	55/53	34	14	181.5036
M 50 x 1,5	36 - 40	60	38	14	181.5040 *
M 63 x 1,5	39 - 44	68/65	41	14	181.6344 *

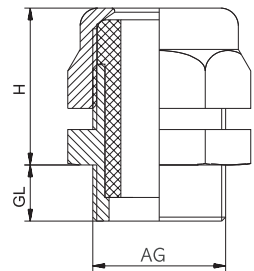





**Uni-Dicht-P / MF**

Material: PA/\*POM  
Farbe: grau (RAL 7032)  
Dichteinsatz: TPE  
Einsatztemperatur: -20 °C bis 100 °C  
Schutzart: IP 68

Material: PA (Nylon)/\*POM  
Colour: grey (RAL 7032)  
Sealing insert: TPE  
Temperature range: -20 °C to 100 °C  
Protection type: IP 68

**181.40**



Gewinde Entry Thread AG	 mm	H mm	GL mm	 mm	HUGRO No.	 mm	HUGRO No.
M 16 x 1,5	19	22	9	2 x 1,2	<b>181.17122.40</b>	4 x 1,4	<b>181.17144.40</b>
M 16 x 1,5	19	22	9	2 x 3	<b>181.17302.40</b>	3 x 3	<b>181.17303.40</b>
M 16 x 1,5	19	22	9	4 x 3	<b>181.17304.40</b>	2 x 4	<b>181.17402.40</b>
M 20 x 1,5	22	23	9			4 x 1,5	<b>181.20154.40</b>
M 20 x 1,5	22	23	9	7 x 1,5	<b>181.20157.40</b>	9 x 1,5	<b>181.20159.40</b>
M 20 x 1,5	22	23	9	6 x 2	<b>181.20206.40</b>	2 x 2,3	<b>181.20232.40</b>
M 20 x 1,5	22	23	9	6 x 2,5	<b>181.20256.40</b>	2 x 3	<b>181.20302.40</b>
M 20 x 1,5	22	23	9	3 x 3	<b>181.20303.40</b>	5 x 3,5	<b>181.20355.40</b>
M 20 x 1,5	22	23	9	2 x 4	<b>181.20402.40</b>	3 x 4	<b>181.20403.40</b>
M 20 x 1,5	22	23	9	2 x 5	<b>181.20502.40</b>	2 x 6	<b>181.20602.40</b>
M 20 x 1,5	24	23	9	8 x 1,5	<b>181.23158.40</b>	3 x 2	<b>181.23203.40</b>
M 20 x 1,5	24	23	9	10 x 2	<b>181.23210.40</b>	2 x 3	<b>181.23302.40</b>
M 20 x 1,5	24	23	9	3 x 3	<b>181.23303.40</b>	4 x 3	<b>181.23304.40</b>
M 20 x 1,5	24	23	9	6 x 3,5	<b>181.23356.40</b>	3 x 4	<b>181.23403.40</b>
M 20 x 1,5	24	23	9	2 x 5	<b>181.23502.40</b>	2 x 6	<b>181.23602.40</b>
M 25 x 1,5	30/27	23	9	7 x 2	<b>181.25207.40</b>	3 x 3	<b>181.25303.40</b>
M 25 x 1,5	30/27	23	9	9 x 3	<b>181.25309.40</b>	2 x 4	<b>181.25402.40</b>
M 25 x 1,5	30/27	23	9	4 x 4	<b>181.25404.40</b>	6 x 4	<b>181.25406.40</b>
M 25 x 1,5	30/27	23	9	2 x 6	<b>181.25602.40</b>	4 x 6	<b>181.25604.40</b>
M 25 x 1,5	30/27	23	9	3 x 7	<b>181.25703.40</b>	2 x 8	<b>181.25802.40</b>
M 32 x 1,5	36/33	27	11	21 x 2	<b>181.32221.40</b>	8 x 3	<b>181.32308.40</b>
M 32 x 1,5	36/33	27	11	6 x 4	<b>181.32406.40</b>	8 x 4	<b>181.32408.40</b>
M 32 x 1,5	36/33	27	11	2 x 4,5	<b>181.32452.40</b>	4 x 5	<b>181.32504.40</b>
M 32 x 1,5	36/33	27	11	6 x 5	<b>181.32506.40</b>	8 x 5	<b>181.32508.40</b>
M 32 x 1,5	36/33	27	11	4 x 6	<b>181.32604.40</b>	4 x 6,5	<b>181.32654.40</b>
M 32 x 1,5	36/33	27	11	6 x 6,5	<b>181.32656.40</b>	3 x 7	<b>181.32703.40</b>
M 32 x 1,5	36/33	27	11	2 x 8	<b>181.32802.40</b>	4 x 8	<b>181.32804.40</b>
M 32 x 1,5	36/33	27	11	2 x 9	<b>181.32902.40</b>	3 x 9	<b>181.32903.40</b>
M 40 x 1,5	46/43	34	11,5	12 x 5,3	<b>181.40512.40</b>	6 x 6	<b>181.40606.40</b>
M 40 x 1,5	46/43	34	11,5	10 x 6	<b>181.40610.40</b>	7 x 7	<b>181.40707.40</b>
M 40 x 1,5	46/43	34	11,5	5 x 8	<b>181.40805.40</b>	6 x 8	<b>181.40806.40</b>
M 40 x 1,5	46/43	34	11,5	4 x 9	<b>181.40904.40</b>	5 x 9	<b>181.40905.40</b>
M 40 x 1,5	46/43	34	11,5	4 x 10	<b>181.40104.40</b>	5 x 10	<b>181.40105.40</b>
M 40 x 1,5	46/43	34	11,5	2 x 11	<b>181.40112.40</b>	3 x 11	<b>181.40113.40</b>
M 40 x 1,5	46/43	34	11,5	2 x 13	<b>181.40132.40</b>		
M 50 x 1,5	55/53	34	14	15 x 5	<b>181.50515.40</b>	13 x 7	<b>181.50713.40</b>
M 50 x 1,5	55/53	34	14	8 x 8	<b>181.50808.40</b>	11 x 8	<b>181.50811.40</b>
M 50 x 1,5	55/53	34	14	7 x 9	<b>181.50907.40</b>	8 x 9	<b>181.50908.40</b>
M 50 x 1,5	55/53	34	14	3 x 10	<b>181.50103.40</b>	4 x 11,5	<b>181.50114.40</b>
M 50 x 1,5	55/53	34	14	5 x 11,5	<b>181.50115.40</b>	4 x 13	<b>181.50134.40</b>
M 50 x 1,5	55/53	34	14	2 x 15	<b>181.50152.40</b>		
M 63 x 1,5 *	68/65	41	14	8 x 10	<b>181.63108.40</b>	4 x 12	<b>181.63124.40</b>
M 63 x 1,5 *	68/65	41	14	8 x 12	<b>181.63128.40</b>	4 x 16	<b>181.63164.40</b>
M 63 x 1,5 *	68/65	41	14	3 x 18	<b>181.63183.40</b>		

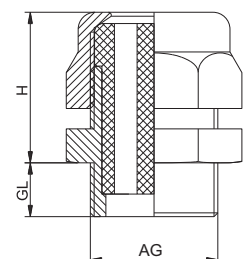

**Auf Anfrage:**

- weitere Ausführungen mit unterschiedlichen Bohrungen
- Bolzen zum Verschließen nicht gebrauchter Bohrungen siehe Zubehör - Serie 683

**On request:**



- further versions with different holes
- Plugs for closing of not used holes see accessories - series 683

## Uni-Dicht-P / MF (Pg)

181.40

Material: PA/\*POM  
Farbe: grau (RAL 7032)  
Dichteinsatz: TPE  
Einsatztemperatur: -20 °C bis 100 °C  
Schutzart: IP 68

Material: PA (Nylon)/\*POM  
Colour: grey (RAL 7032)  
Sealing insert: TPE  
Temperature range: -20 °C to 100 °C  
Protection type: IP 68

Gewinde Entry Thread AG	 mm	H mm	GL mm	 mm	HUGRO No.	 mm	HUGRO No.
Pg 9	19	22	9	2 x 1,2	181.09122.40	4 x 1,4	181.09144.40
Pg 9	19	22	9	2 x 3	181.09302.40	3 x 3	181.09303.40
Pg 9	19	22	9	4 x 3	181.09304.40	2 x 4	181.09402.40
Pg 11	22	23	9			4 x 1,5	181.11154.40
Pg 11	22	23	9	7 x 1,5	181.11157.40	9 x 1,5	181.11159.40
Pg 11	22	23	9	6 x 2	181.11206.40	2 x 2,3	181.11232.40
Pg 11	22	23	9	6 x 2,5	181.11256.40	2 x 3	181.11302.40
Pg 11	22	23	9	3 x 3	181.11303.40	5 x 3,5	181.11355.40
Pg 11	22	23	9	2 x 4	181.11402.40	3 x 4	181.11403.40
Pg 11	22	23	9	2 x 5	181.11502.40	2 x 6	181.11602.40
Pg 13,5	24	23	9	8 x 1,5	181.13158.40	3 x 2	181.13203.40
Pg 13,5	24	23	9	10 x 2	181.13210.40	2 x 3	181.13302.40
Pg 13,5	24	23	9	3 x 3	181.13303.40	4 x 3	181.13304.40
Pg 13,5	24	23	9	6 x 3,5	181.13356.40	3 x 4	181.13403.40
Pg 13,5	24	23	9	2 x 5	181.13502.40	2 x 6	181.13602.40
Pg 16	27	23	9,5	7 x 2	181.16207.40	3 x 3	181.16303.40
Pg 16	27	23	9,5	9 x 3	181.16309.40	2 x 4	181.16402.40
Pg 16	27	23	9,5	4 x 4	181.16404.40	6 x 4	181.16406.40
Pg 16	27	23	9,5	2 x 6	181.16602.40	4 x 6	181.16604.40
Pg 16	27	23	9,5	3 x 7	181.16703.40	2 x 8	181.16802.40
Pg 21	33	27	11	21 x 2	181.21221.40	8 x 3	181.21308.40
Pg 21	33	27	11	6 x 4	181.21406.40	8 x 4	181.21408.40
Pg 21	33	27	11	2 x 4,5	181.21452.40	4 x 5	181.21504.40
Pg 21	33	27	11	6 x 5	181.21506.40	8 x 5	181.21508.40
Pg 21	33	27	11	4 x 6	181.21604.40	4 x 6,5	181.21654.40
Pg 21	33	27	11	6 x 6,5	181.21656.40	3 x 7	181.21703.40
Pg 21	33	27	11	2 x 8	181.21802.40	4 x 8	181.21804.40
Pg 21	33	27	11	2 x 9	181.21902.40	3 x 9	181.21903.40
Pg 29	43	34	11,5	12 x 5,3	181.29512.40	6 x 6	181.29606.40
Pg 29	43	34	11,5	10 x 6	181.29610.40	7 x 7	181.29707.40
Pg 29	43	34	11,5	5 x 8	181.29805.40	6 x 8	181.29806.40
Pg 29	43	34	11,5	4 x 9	181.29904.40	5 x 9	181.29905.40
Pg 29	43	34	11,5	4 x 10	181.29104.40	5 x 10	181.29105.40
Pg 29	43	34	11,5	2 x 11	181.29112.40	3 x 11	181.29113.40
Pg 29	43	34	11,5	2 x 13	181.29132.40		
Pg 36	53	34	14	15 x 5	181.36515.40	13 x 7	181.36713.40
Pg 36	53	34	14	8 x 8	181.36808.40	11 x 8	181.36811.40
Pg 36	53	34	14	7 x 9	181.36907.40	8 x 9	181.36908.40
Pg 36	53	34	14	3 x 10	181.36103.40	4 x 11,5	181.36114.40
Pg 36	53	34	14	5 x 11,5	181.36115.40	4 x 13	181.36134.40
Pg 36	53	34	14	2 x 15	181.36152.40		
Pg 48 *	65	41	15	8 x 10	181.48108.40	4 x 12	181.48124.40
Pg 48 *	65	41	15	8 x 12	181.48128.40	4 x 16	181.48164.40
Pg 48 *	65	41	15	3 x 18	181.48183.40		

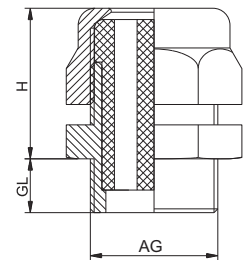

### Auf Anfrage:

- weitere Ausführungen mit unterschiedlichen Bohrungen
- Bolzen zum Verschließen nicht gebrauchter Bohrungen siehe Zubehör - Serie 683

### On request:

- further versions with different holes
- Plugs for closing of not used holes see accessories - series 683