

EXPLO

Material: Messing vernickelt
Schrauben: rostfreier Stahl A2
Dichtensatz: NBR
O-Ring: NBR
Einsatztemperatur: -40 °C bis 100 °C
Schutzart: IP 68 (30 bar)/IP 69K

Material: brass, nickel-plated
Screws: stainless steel A2
Sealing insert: NBR
O-ring: NBR
Temperature range: -40 °C to 100 °C
Protection type: IP 68 (30 bar)/IP 69K

118.00

Zertifikate: PTB 00 ATEX 1059
IECEX PTB 12.0056

Certificates: PTB 00 ATEX 1059
IECEX PTB 12.0056

Weitere internationale Zulassungen vorhanden

Further international approvals available



Gewinde Entry Thread AG	mm	mm	A mm	H mm	GL mm	EXPLO No.	HUGRO No.
M 16 x 1,5	7 - 9	20	27	57	12	1817.09.26	118.1709
M 20 x 1,5	9 - 11	24	30	57	12	1820.11.26	118.2011
M 20 x 1,5	11 - 13	26	32	57	14	1820.16.26	118.2013
M 25 x 1,5	13 - 16,5	32	40	67	16	1825.21.26	118.2516
M 25 x 1,5	16,5 - 20	36	44	67	16	1825.21.27	118.2520
M 32 x 1,5	20 - 24	45	48	78	17	1832.29.26	118.3224
M 40 x 1,5	24 - 28	45	52	78	17	1840.29.27	118.4028
M 50 x 1,5	28 - 32	55	60	85	17	1850.36.26	118.5032
M 50 x 1,5	32 - 36	55	64	85	17	1850.36.27	118.5036
M 63 x 1,5	36 - 40	70	75	88	20	1863.48.26	118.6340
M 63 x 1,5	40 - 44	70	80	88	20	1863.48.27	118.6344
Pg 9	7 - 9	20	27	57	12	1809.26	118.0909
Pg 11	9 - 11	24	30	57	12	1811.26	118.1111
Pg 13,5	11 - 13	26	32	57	14	1813.26	118.1313
Pg 16	11 - 13	26	32	57	14	1816.26	118.1613
Pg 21	13 - 16,5	32	40	67	16	1821.26	118.2116
Pg 21	16,5 - 20	36	44	67	16	1821.27	118.2120
Pg 29	20 - 24	45	48	78	17	1829.26	118.2924
Pg 29	24 - 28	45	52	78	17	1829.27	118.2928
Pg 36	28 - 32	55	60	85	17	1836.26	118.3632
Pg 36	32 - 36	55	64	85	17	1836.27	118.3636
Pg 48	36 - 40	64	75	88	20	1848.48.26	118.4840
Pg 48	40 - 44	64	80	88	20	1848.48.27	118.4844
3/8" NPT	7 - 9	20	27	57	15,5	18 3/8 NPT.09.26	118.3909
1/2" NPT	9 - 11	24	30	57	20	18 1/2 NPT.11.26	118.1911
1/2" NPT	11 - 13	26	32	57	20	18 1/2 NPT.16.26	118.1913
3/4" NPT	9 - 11	27	30	57	20	18 3/4 NPT.11.26	118.3511
3/4" NPT	11 - 13	26	32	57	20	18 3/4 NPT.16.26	118.3513
3/4" NPT	13 - 16,5	32	40	67	20	18 3/4 NPT.21.26	118.3516
1" NPT	13 - 16,5	32	40	67	25	18 1 NPT.21.26	118.7516
1" NPT	16,5 - 20	36	44	67	25	18 1 NPT.21.27	118.7520
1 1/4" NPT	20 - 24	45	48	78	26	18 1 1/4 NPT.29.26	118.7624
1 1/4" NPT	24 - 28	45	52	78	26	18 1 1/4 NPT.29.27	118.7628
1 1/2" NPT	28 - 32	55	60	85	26	18 1 1/2 NPT.36.26	118.7732
1 1/2" NPT	32 - 36	55	64	85	26	18 1 1/2 NPT.36.27	118.7736
G 3/8"	7 - 9	20	27	57	12	183/8G.09.26	118.3809
G 1/2"	9 - 11	24	30	57	14	181/2G.11.26	118.1211
G 1/2"	11 - 13	26	32	57	14	181/2G.16.26	118.1213
G 3/4"	13 - 16,5	32	40	67	16	183/4G.21.26	118.3416
G 3/4"	16,5 - 20	36	44	67	16	183/4G.21.27	118.3420
G 1"	20 - 24	45	48	78	17	181G.29.26	118.8524
G 1 1/4"	24 - 28	45	52	78	17	181 1/4G.29.27	118.8728
G 1 1/2"	28 - 32	55	60	85	17	181 1/2G.36.26	118.8932
G 2"	36 - 40	64	75	88	20	1848.26	118.9148
G 2"	40 - 44	64	80	88	20	1848.27	118.9144

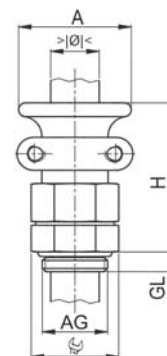

Auf Anfrage:

- für höhere Temperaturen

On request:

- for higher temperatures